

PULL PLATES

PART NUMBER	Range	T Thread	D" Dia	H"
XAA 221	5 TO 25 LB	1/4-28 UNF	2.50	.75
XAA 222	50 to 1K LB	3/8-24 UNF	3.00	1.00
XAA 223	2K to 5K LB	1/2-20 UNF	3.5	1.00
XAA 224	7500 to 15K LB	1-14 UNS	5.50	1.50
XAA 225	20 K to 50 K LB	1 1/2-12 UNF	6.00	1.80
XAA 226	75K to 100K LB	2-12UNC	7.50	2.50
XAA 227	150K to 200K LB	2 1/2-12 UN	9.00	3.00
XAA 228	300K to 400K BL	3 1/2-8 UN	14.00	4.25

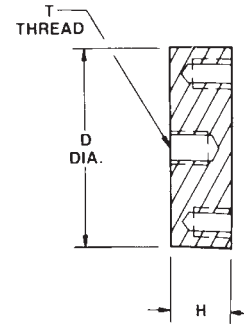

EYE BOLTS

PART NUMBER	Thread	Inside Eye Dia	Overall Lght	Safe load (lb)
XEL 101	1/4-28 UNF	3/4	2 1/4	400
XEL 102	3/8-24 UNF	1	3	1400
XEL 103	1/2-20 UNF	1 3/16	3 1/2	2600
XEL 104	5/8-18 UNF	1 3/8	4 1/2	4000
XEL 105	3/4-16 UNF	1 1/2	5	6000
XEL 106	1-14 UNF	1 13/16	6	8000
XEL 107	1 1/4 UNF	2 3/16	6	8000

MATERIAL: Forged Steel & Zinc Plated

